

STEELIE®

PEDESTAL KIT & HOBKNOB™ KIT

STEELIE® USES HIGH PERFORMANCE 3M® VHB® FOAM ADHESIVE. FOR BEST RESULTS, FOLLOW THESE INSTRUCTIONS CAREFULLY. MAGNETIC TABLET SOCKET SHOULD BE INSTALLED IN ROOM TEMPERATURE ENVIRONMENT (60°F [16°C] OR HIGHER)

WARNING!—PLEASE READ

FOR HOBKNOB KIT ONLY: DO NOT CONNECT TABLET SOCKET TO HOBKNOB HANDLE BEFORE INSTALLING TABLET SOCKET ONTO DEVICE. UNATTACHED, THE TWO ARE VERY DIFFICULT TO SEPARATE.



MAGNETIC TABLET SOCKET INSTALLATION INSTRUCTIONS:

1. CLEAN THE BACK OF THE TABLET OR TABLET CASE WITH THE ENCLOSED ALCOHOL PAD. LET DRY. DO NOT USE HOUSEHOLD CLEANERS.
2. REMOVE THE ADHESIVE BACKING FROM THE MAGNETIC TABLET SOCKET.
3. POSITION THE MAGNETIC TABLET SOCKET IN THE CENTER OF THE BACK OF DEVICE AND FIRMLY PRESS INTO PLACE.
4. WAIT AT LEAST 1 HOUR FOR ADHESIVE TO BOND BEFORE USING. PLACE DEVICE FACE UP WHILE CURING SO WEIGHT OF DEVICE HELPS SECURE THE BOND.



MAGNETIC TABLET SOCKET



MAGNETIC TABLET SOCKET
ADHESIVE BACKING



5A. FOR PEDESTAL KIT: FIRMLY PRESS TABLETOP STAND INTO TABLETOP STAND BASE, MAKING SURE STAND IS FULLY INSERTED INTO BASE. POSITION DEVICE ON TABLETOP STAND. (SEE IMAGE 5A)



5B. FOR HOBKNOB KIT: CONNECT HOBKNOB HANDLE TO DEVICE. (SEE IMAGE 5B)

DO NOT USE THESE PRODUCTS ON SOFT, FLEXIBLE TABLET CASES. THESE CASES ARE NOT RIGID ENOUGH TO HOLD THE MAGNETIC TABLET SOCKET. IN THE EVENT THAT YOU MUST USE THE MAGNETIC TABLET SOCKET WITH A SOFT, FLEXIBLE CASE: REMOVE THE CASE FROM YOUR TABLET, PLACE THE CASE ON A SOLID SURFACE AND CUT A HOLE IN THE CASE WHERE THE MAGNETIC TABLET SOCKET WILL BE APPLIED, THEN ADHERE MAGNETIC TABLET SOCKET DIRECTLY TO THE HARD SURFACE BELOW, THROUGH THE NEW HOLE IN CASE.

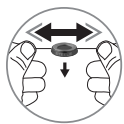

REMOVAL INSTRUCTIONS:

1. APPLY A FEW DROPS OF RUBBING ALCOHOL BETWEEN THE STEELIE COMPONENT AND THE SURFACE OR DEVICE IT HAS BEEN APPLIED TO IN ORDER TO BREAK THE ADHESIVE BOND.
2. CAREFULLY USE FISHING LINE OR DENTAL FLOSS IN A SAWING MOTION TO CUT FOAM AWAY FROM THE SURFACE OR DEVICE. (SEE ILLUSTRATION BELOW) USING YOUR FINGER, ROLL REMAINING ADHESIVE AWAY FROM APPLIED SURFACE.

CAUTION! USE OF SHARP EDGES TO REMOVE ADHESIVE IS NOT RECOMMENDED, AS IT MAY RESULT IN SCRATCHES OR DAMAGE TO DEVICES AND/OR OTHER SURFACES!

3. DO NOT RE-USE 3M ADHESIVE. NEW ADHESIVES CAN BE PURCHASED WITHIN A REINSTALL KIT AT WWW.NITEIZE.COM.

MAGNET WARNING—PLEASE READ

THE STEELIE CONTAINS A STRONG MAGNET. THE MAGNET WILL NOT DAMAGE PHONES OR TABLETS WITH SOLID STATE HARD DRIVES (INCLUDING IPHONES, IPADS, ETC.) AS APPLE HAS SHOWN WITH THE IPAD SMARTCOVERS.

HOWEVER, MAGNETS CAN DAMAGE SENSITIVE OBJECTS INCLUDING PACEMAKERS, COMPUTER HARD-DRIVES, FLOPPY DISKS, CREDIT CARDS, MAGNETIC I.D. CARDS, CASSETTE TAPES, VIDEO TAPES AND OTHER SIMILAR ITEMS. CERTAIN TELEVISIONS, VCRS, COMPUTER MONITORS AND OTHER CRT DISPLAYS MAY ALSO BE AFFECTED. NITE IZE ASSUMES NO LIABILITY FOR DAMAGE TO SUCH OBJECTS.

KEEP OUT OF REACH OF CHILDREN. MAGNETS CAN BE HARMFUL IF SWALLOWED.